

GP1670F connection to Standard NMEA 2000 Backbone (with example NMEA 2000 Device)

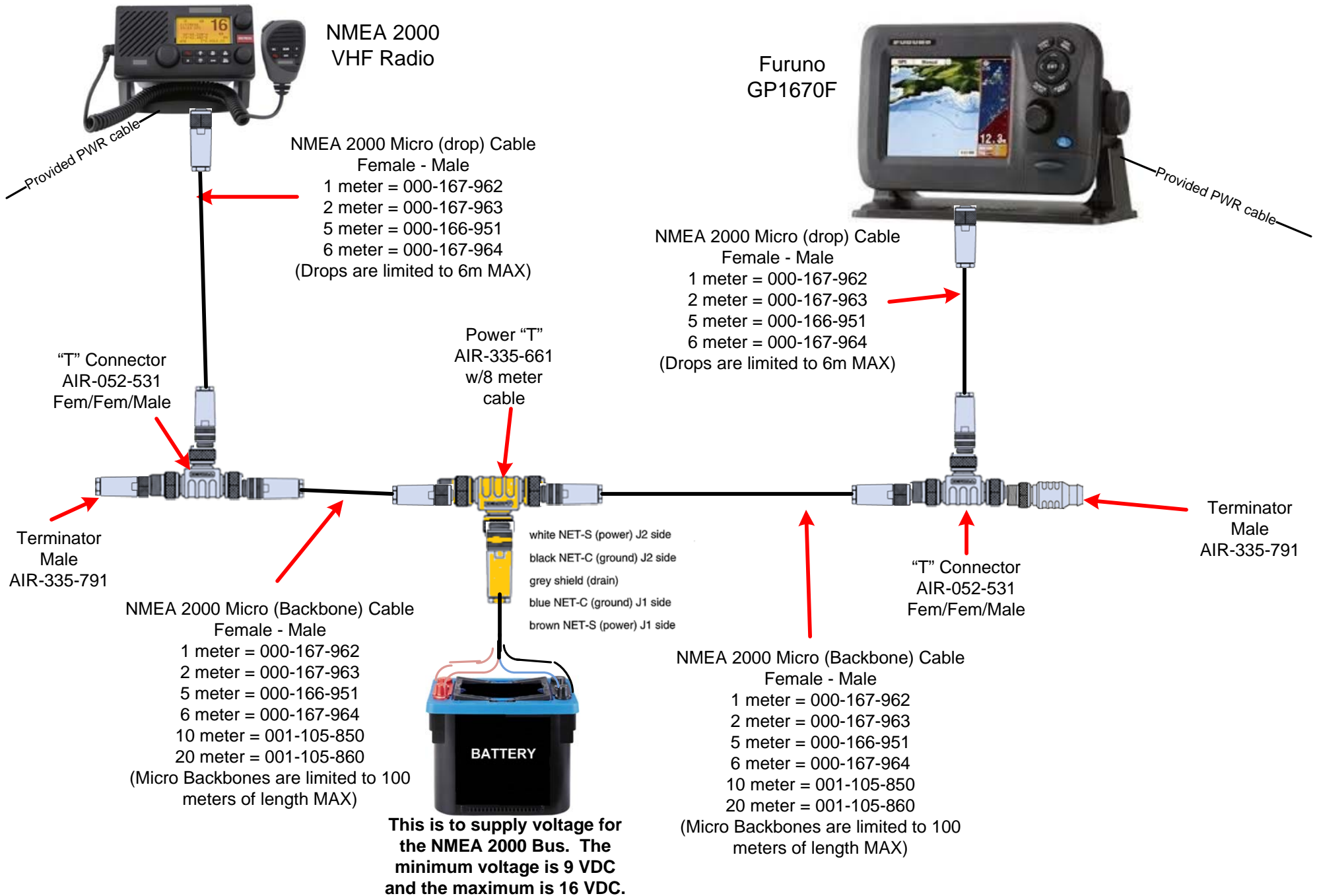

GP1670F connection to NMEA 2000 device using Furuno CANbus FI-5002 Junction Box

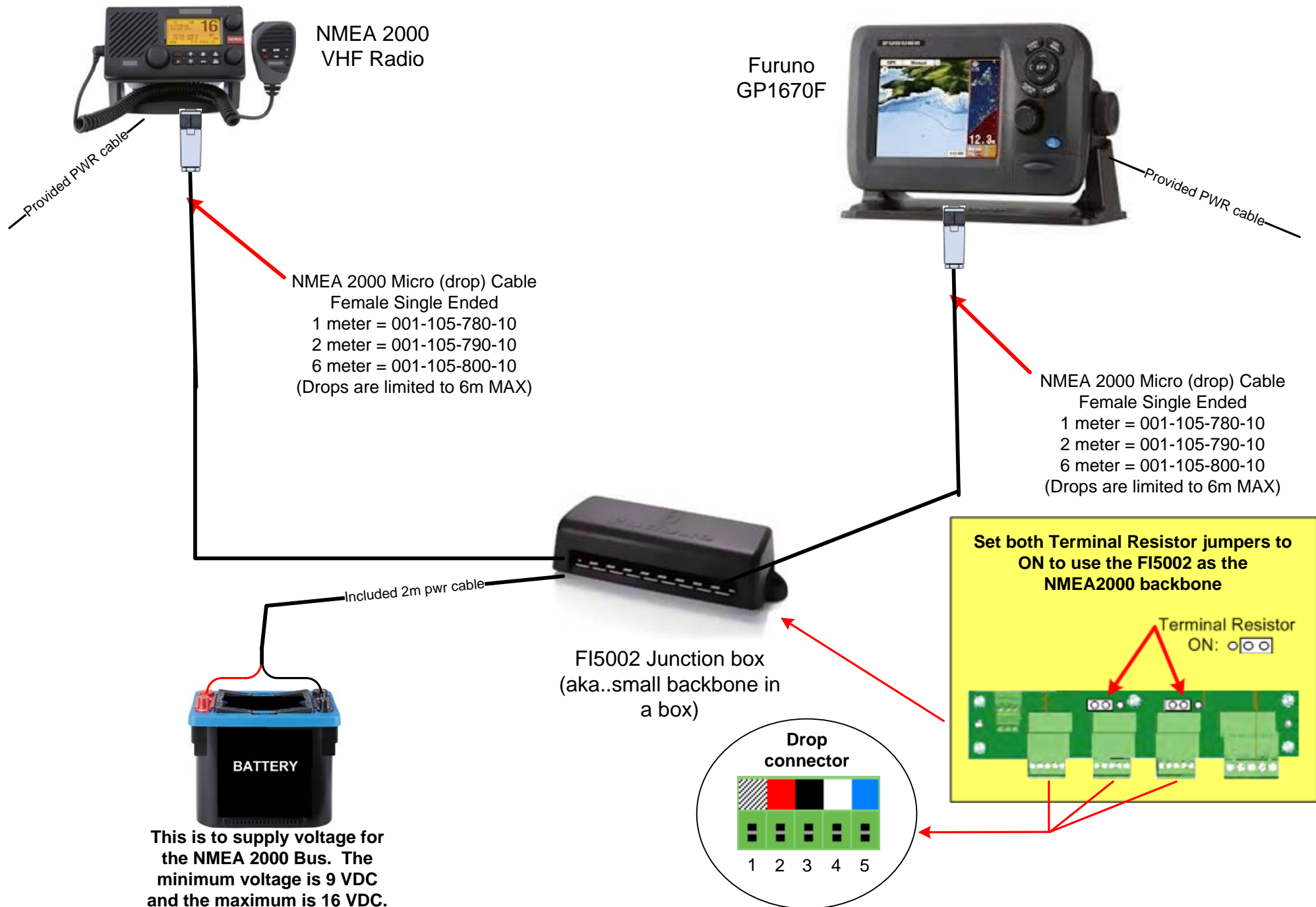

GP1670F NMEA 2000 Connection to NMEA 0183 Device Using Furuno CANbus

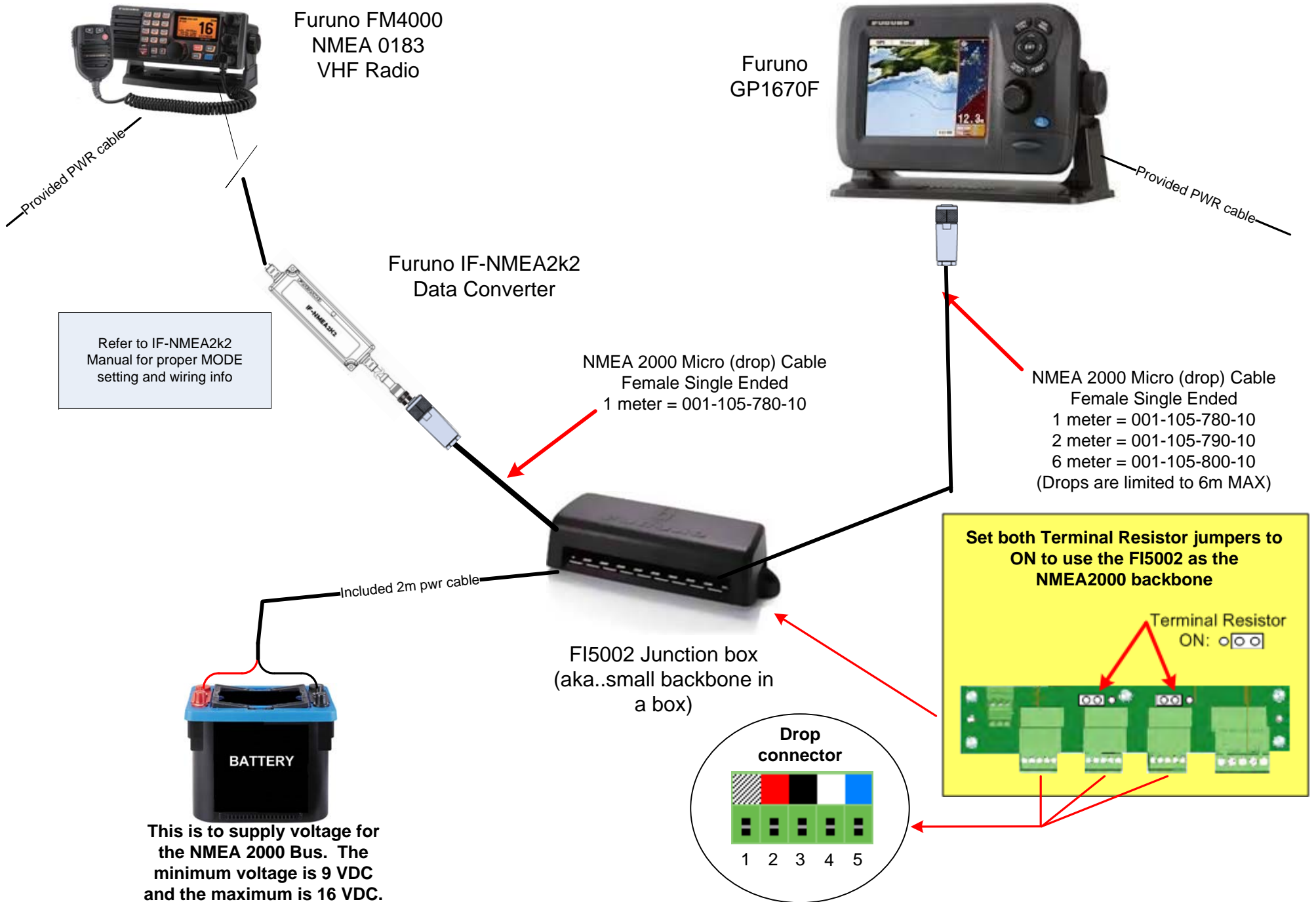

GP1670F connection to NMEA 2000 Backbone (with NMEA 0183 Device)

