

**12.4.2 Gate-valve tank: DS-786**

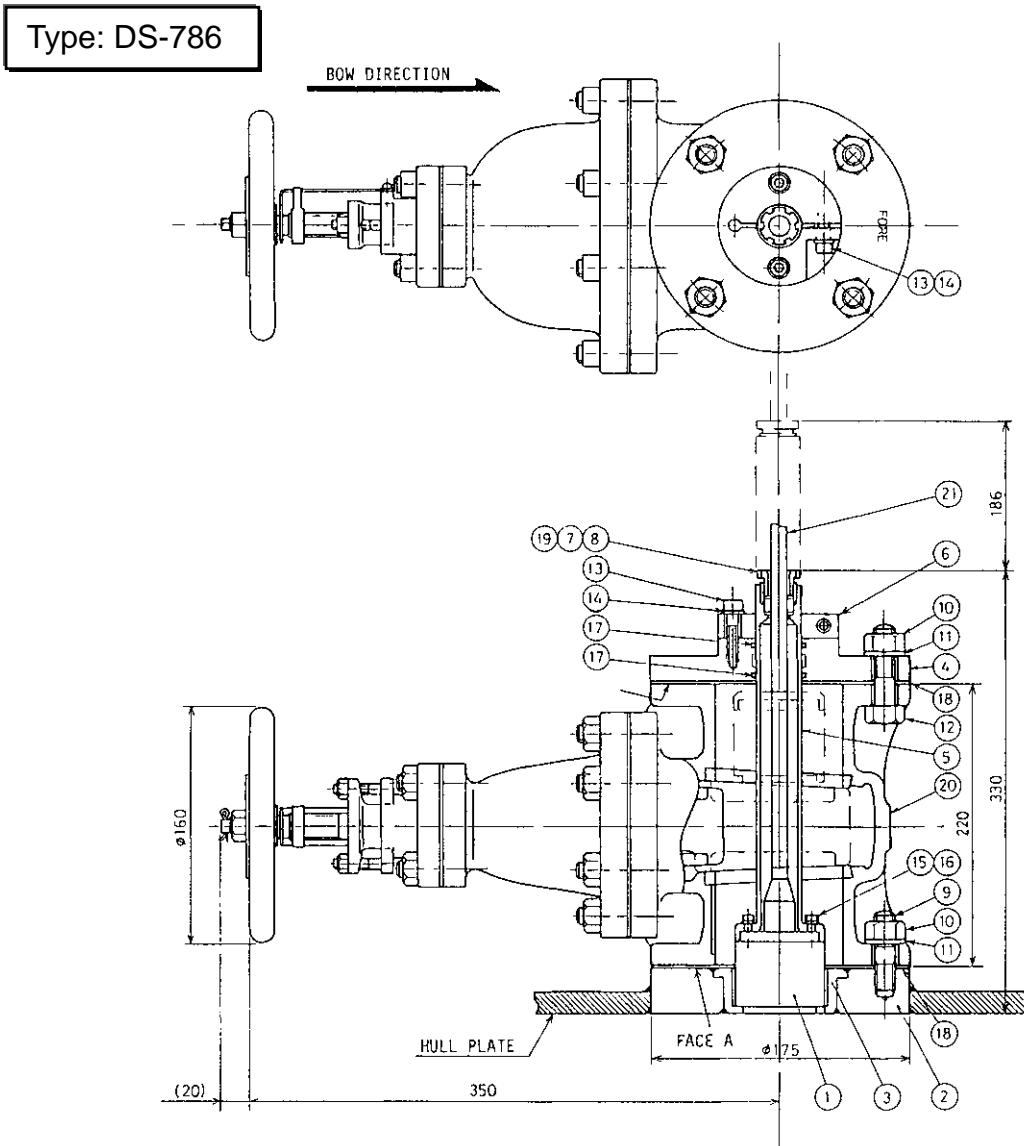

No.		QTY.	No.		QTY.
1	TRANSDUCER	1	12	HEX.BOLT	4
2	HULL FLANGE	1	13	HEX. SOCKET HEAD BOLT	3
3	BUSHING		14	SPRING WASHER	3
4	FLANGE	1	15	HEX. SOCKET HEAD BOLT	4
5	SHAFT	1	16	SEAL WASHER	4
6	LOCK RING	1	17	O RING	2
7	GASKET	1	18	GASKET	2
8	WASHER	2	19	FIXING GLAND	1
9	TAP-END STUD BOLT	4	20	GATE VALVE	1
10	HEX. NUT	8	21	CONNECTION CABLE	
11	SPRING WASHER	8			

*Fig. 12.4.5 DS-80 Gate-valve hull tank: DS-786*

**1. Mounting of transducer**

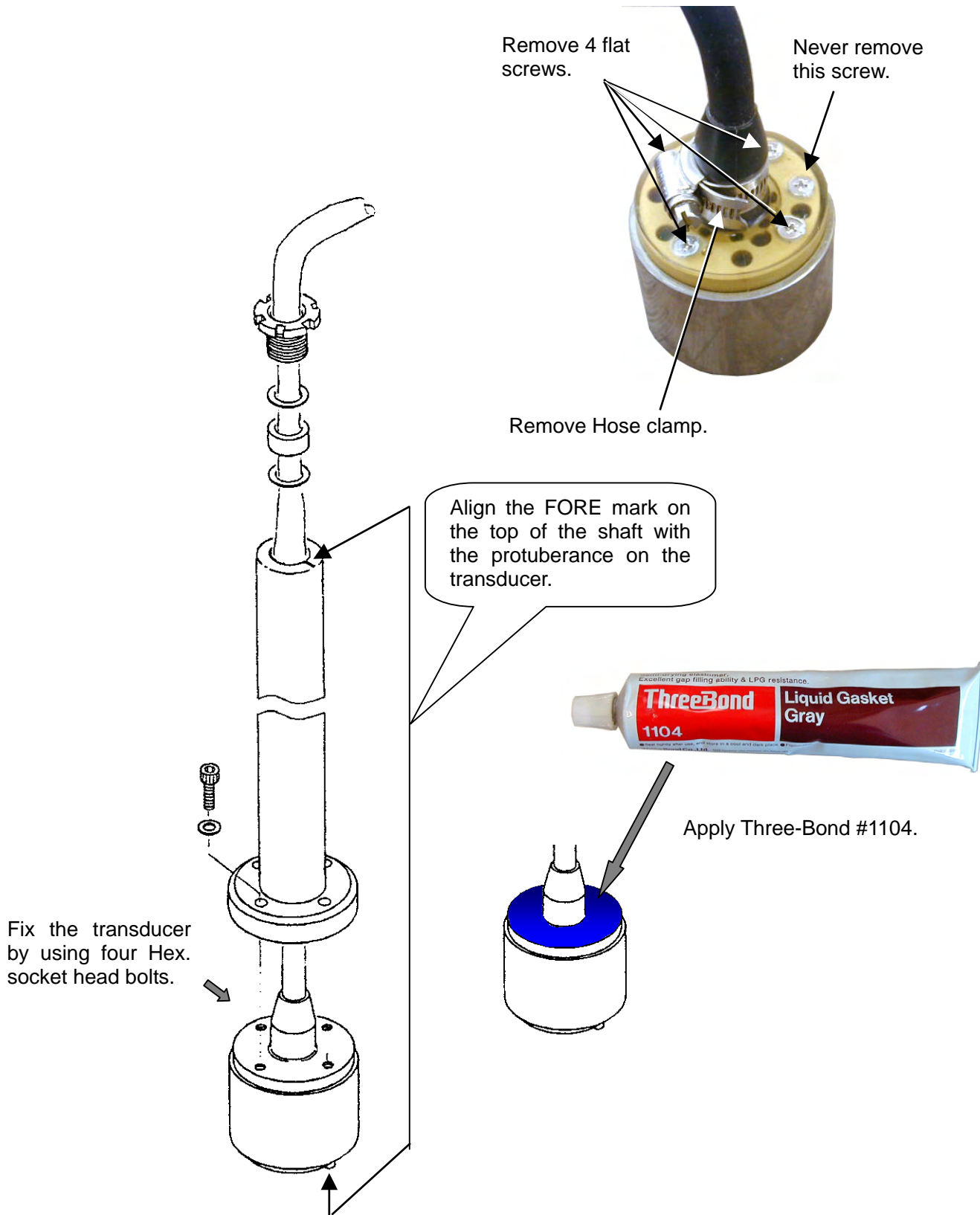

*Fig. 12.4.6 Mounting DS-80 transducer*

**2. Weld the hull flange with FORE mark aligned to the bow direction and the reference marks to the fore-aft line.**

- Fore-aft alignment is accurate within  $\pm 1$  degree.
- The flange must be parallel to the draft line within  $\pm 1$  degree.
- Grind the welding area outside the hull bottom to accomplish flatness.

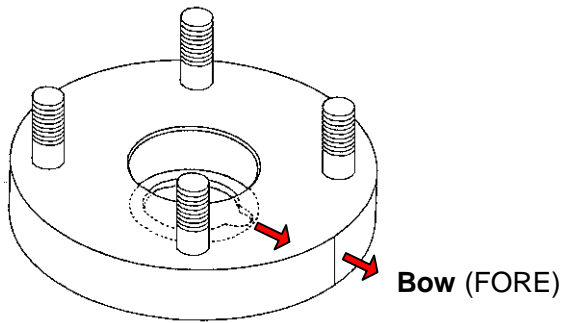

*Fig.12.4.7 Mounting bottom flange*

Apply KINORUSTER or alternative anticorrosive sealant to the flanges and the gasket as shown in Fig. 12.4.8. Use the sealant for both side of the gasket.



Align FORE mark on the flange with that on the bottom flange.

Align FORE mark on the top of the shaft with that on the flange.

Confirm that the transducer face flushes with the hull bottom.

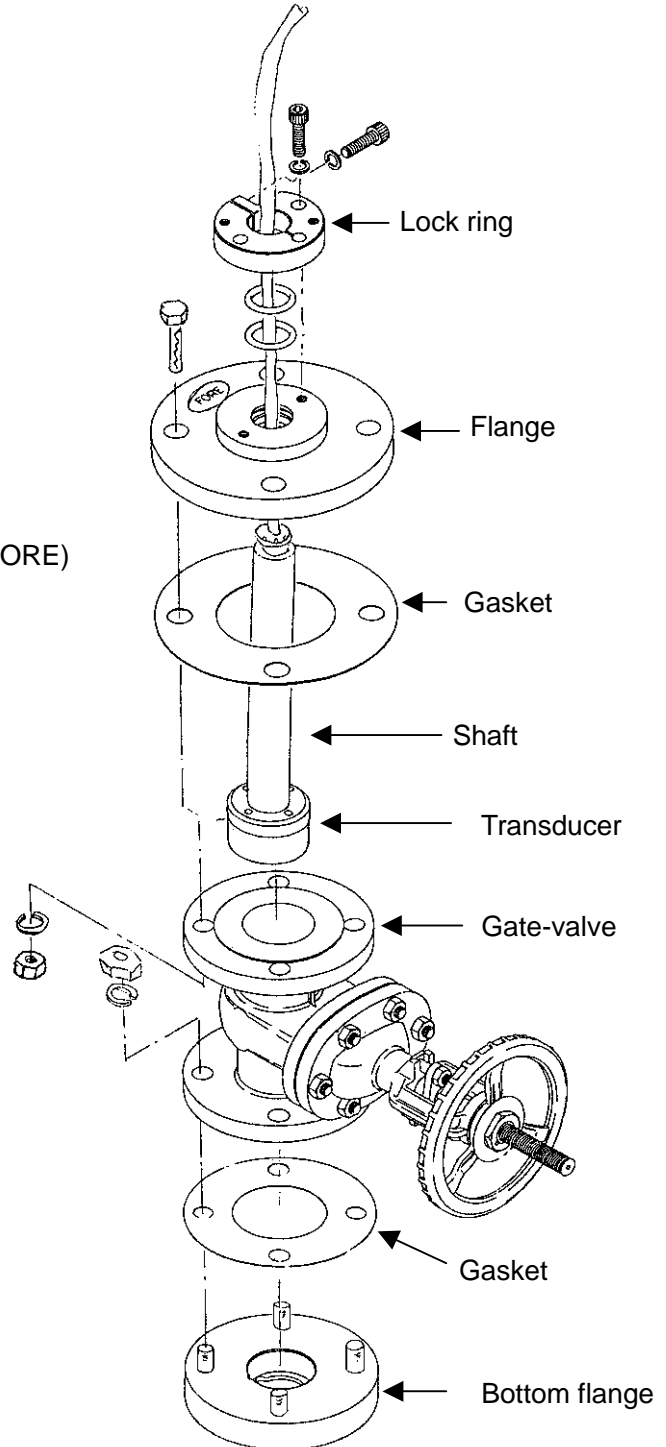

*Fig. 12.4.8 DS-786, enlarged*